

ARPELLA

Please Read Before Installation

Please read these instructions carefully before starting installation and keep in a safe place for future reference. Manufacturer recommends using a qualified Electrician for all electrical wiring procedures. Please turn off all power to site prior to installation.

Check the contents of the pack carefully before installation. Manufacturer is not responsible for removal/reinstallation costs where a defective product has been installed. If any fault is found with materials or workmanship, it must be reported immediately to the manufacturer. Remedial action will be taken, based on information received, on condition that.

- 1, Full details are supplied to the manufacturer,
 - 2 The product has not been modified or tampered with.
 - 3, The manufacturer is informed of any damage short ages prior to installation.
 - 4, The product has not been installed, or attempts have been made to install.
- We do not accept responsibility for any problems that may occur through incorrect installation.

IMPORTANT SAFETY INSTRUCTION

When using an electrical furnishing, basic precautions should always be followed, including the following:

Read all instructions before using (this furnishing).

DANGER - To reduce the risk of electric shock:

1. Always unplug this furnishing from the electrical outlet before cleaning or servicing.

WARNING - To reduce the risk of burns, fire, electric shock, or injury to persons:

2. Unplug from outlet before putting on or taking off parts.
3. Close supervision is necessary when this furnishing is used by, or near children, invalids, or disabled persons.
4. Use this furnishing only for its intended use as described in these instructions. Do not use attachments not recommended by the manufacturer.
5. Never operate this furnishing if it has a damaged cord or plug, if it is not working properly, if it has been dropped or damaged, or dropped into water. Return the furnishing to a service center for examination and repair.
6. Keep the cord away from heated surfaces.
7. Never operate the furnishing with the air openings blocked. Keep the air openings free of lint, hair, and the like.
8. Never drop or insert any object into any opening.
9. Do not use outdoors.

10. Do not operate where aerosol (spray) products are being used or where oxygen

is being administered.

11. To disconnect, turn all controls to the off position, then remove plug from outlet.

12. For grounded products the following statement:

"WARNING: Risk of Electric Shock - Connect this furnishing to a properly grounded outlet only. See Grounding Instructions.

GROUNDING INSTRUCTIONS

This product must be connected to a grounded metal, permanent wiring system, or an equipment-grounding conductor must be run with the circuit conductors and connected to the equipment-grounding terminal or lead on the product.

SAVE THESE INSTRUCTIONS

Installation Instructions

SUGGESTED TOOLS AND MATERIALS

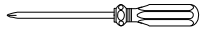

Screwdriver

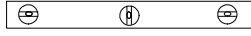

Level



Drill



Tape Measure

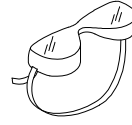

Safety Glasses



Pencil

PARTS & HAREWARE INCLUDED



Anchor 6x

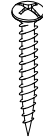

Screw 6x

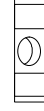

Level 1x

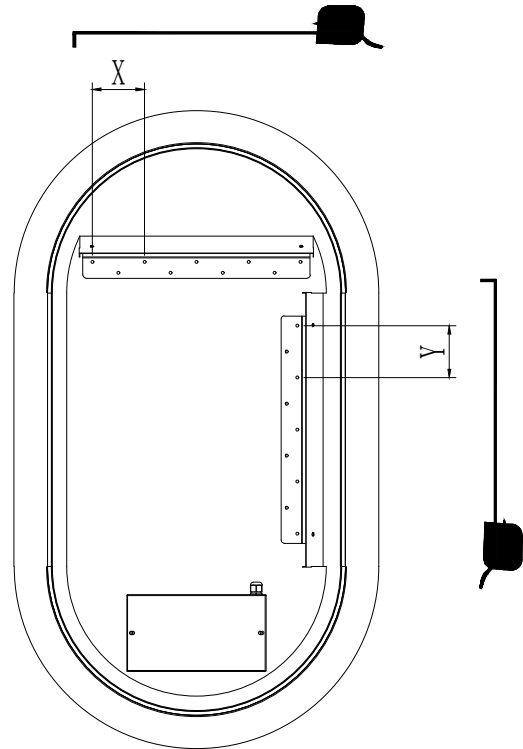
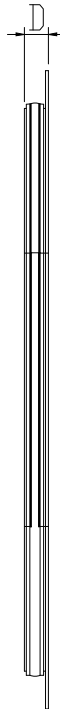
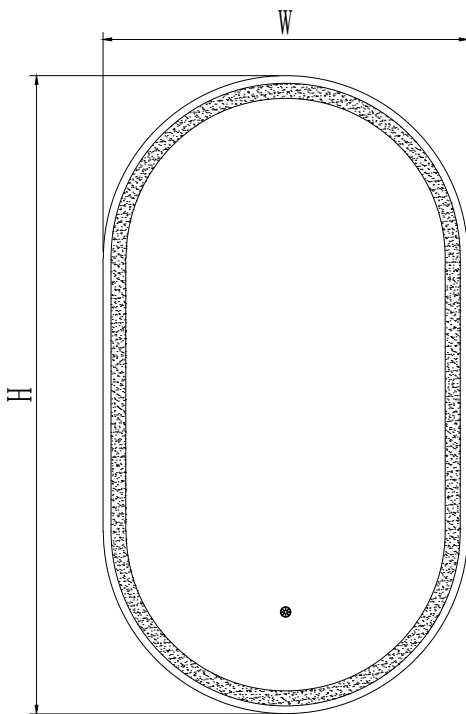

Installation Instructions

SUGGESTED TOOLS AND MATERIALS

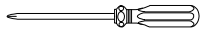

Screwdriver



Level



Drill



Tape Measure



Safety Glasses



Pencil

PARTS & HAREWARE INCLUDED



Anchor 8x



Screw 8x

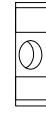

Level 1x

INSTALLATION INSTRUCTIONS

① Drywall

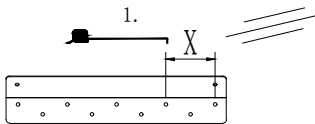

1>Put the hanging cleat on the wall, confirm the position of the hanging cleat, and level the hook with a level ruler

Remark: When installing this product, the screws must reach the wood studs behind the plasterboard wall.

②

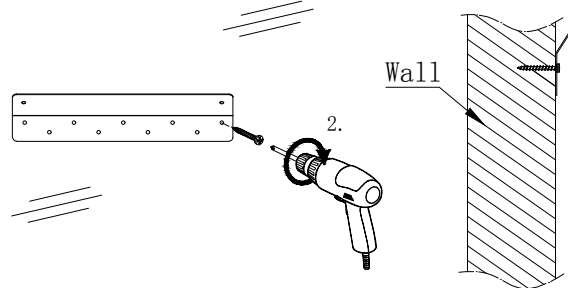

2>Use 5x45mm screws to hang cleat to wall(Use at least 5 screws).

③

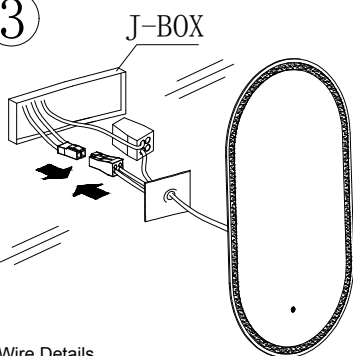

4)Wire Details

Please note, all electrical installations should be carried out by a fully qualified electrician in conformance with the National Electrical Code and local building codes. **TURN OFF POWER BEFORE WIRING.**

Before proceeding to power supply wiring, ensure the MC cable is brought in through the wall and into the chassis knockout. 100mm wire should be left extending into the metal fixture to make connections.

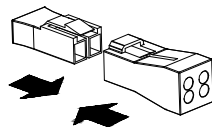

Wiring steps

- 1> Unplug the female terminal of the quick connection terminal of the product
- 2> The pulled out female end is connected with the wall cable
- 3> After completing the second step, insert the female terminal back into the male terminal, and then complete the wiring

Wiring from light fitting

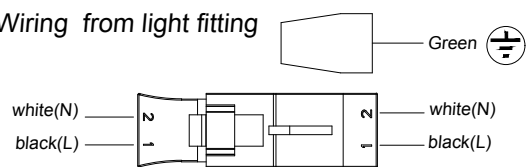

4)Continued

The power wire is inserted into the black port and neutral wire is inserted into the white port. Turn on power to test lamps.

② Vertical direction

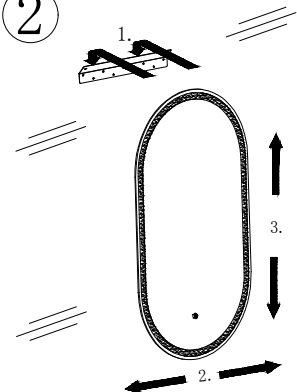

Horizontal direction

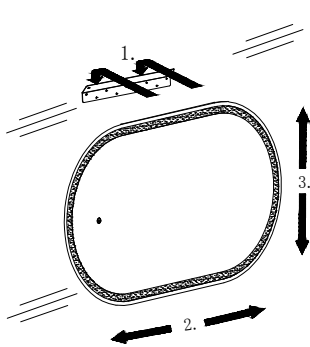

Hang the mirror onto the wall.

④

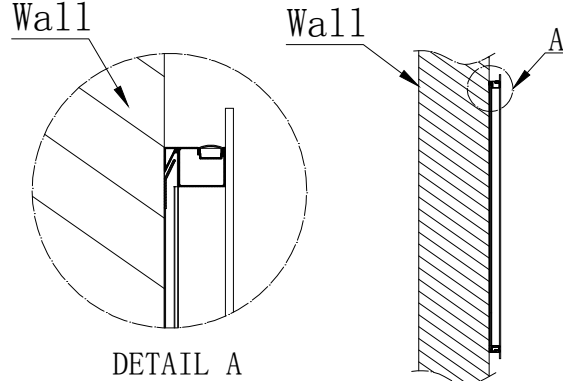

Installation Instructions

SUGGESTED TOOLS AND MATERIALS

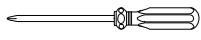

Screwdriver



Level



Drill



Tape Measure

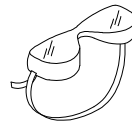

Safety Glasses



Pencil

PARTS & HAREWARE INCLUDED



Anchor 8x



Screw 8x

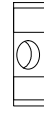

Level 1x

INSTALLATION INSTRUCTIONS

① CONCRETE WALL Clay Brick wall

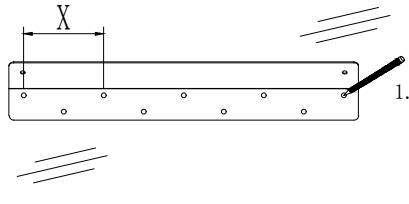

- 1>Level the hanging cleat with a level ruler and mark the installation hole position of the hanging cleat with a pencil
- 2>Drill holes

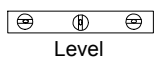

Level

②

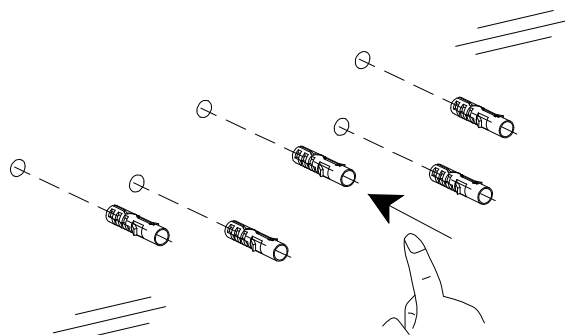

Insert the anchors into the wall(Use at least 5 anchors).

③

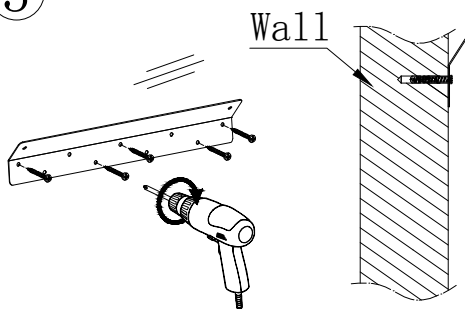

Install the hanging plate onto the wall.
Use 5x45mm screws to hang plate to wall(Use at least 8 screws).

④

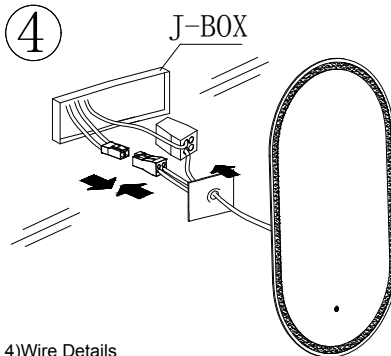

4)Wire Details

Please note, all electrical installations should be carried out by a fully qualified electrician in conformance with the National Electrical Code and local building codes.
TURN OFF POWER BEFORE WIRING.
Before proceeding to power supply wiring, ensure the MC cable is brought in through the wall and into the chassis knockout. 100mm wire should be left extending into the metal fixture to make connections.

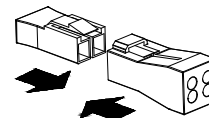

Wiring steps

- 1> Unplug the female terminal of the quick connection terminal of the product
- 2> The pulled out female end is connected with the wall cable
- 3> After completing the second step, insert the female terminal back into the male terminal, and then complete the wiring

④

Wiring from light fitting



4)Continued

The power wire is inserted into the black port and neutral wire is inserted into the white port. Turn on power to test lamps.

⑤ Vertical direction

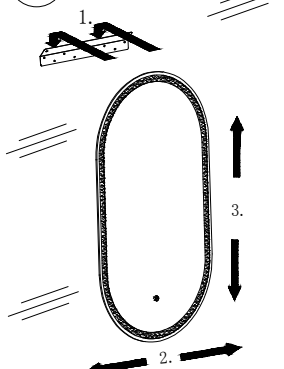

Horizontal direction

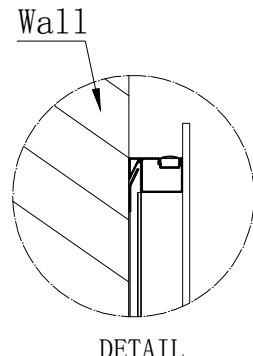
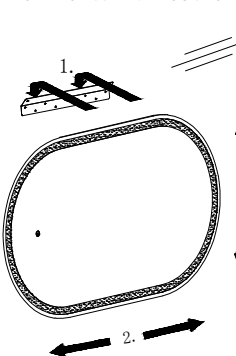

DETAIL

Hang the mirror onto the wall.