

Model No: SRU201609

Overall size:

21 $\frac{7}{8}$ " X 17 $\frac{3}{16}$ " X 8 $\frac{1}{16}$ "

FEATURES:

Type 304 stainless steel

18 Gauge thickness

Satin finish.

INSTALLATION

Undermount installation

Supplied With Cutout  
template.

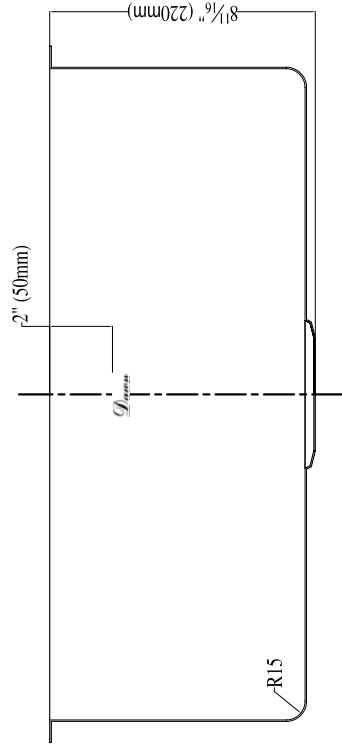

Dawn Kitchen & Bath Products, Inc.