

D-Code Furniture washbasin & # 03426500002 / 03426500302

| < 25 5/8" Inch > |

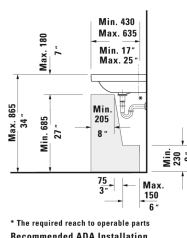

* The required reach to operable parts
Recommended ADA Installation

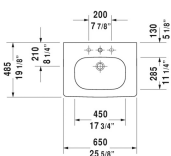
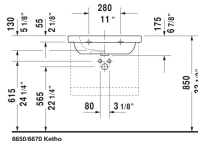
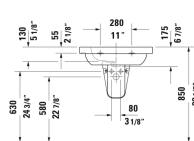
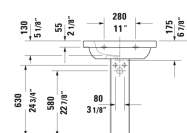

| Furniture washbasin | Dimension | Weight | Order number |
|---|------------------------|---------|--------------|
| with overflow, with faucet deck, underside fully glazed, hardware included, wall-mounted, 25 5/8" Inch | | | |
| Colors | | | |
| 00 White | | | |
| Variant | | | |
| ● | 25 5/8" x 19 1/8" Inch | 44.3 lb | 03426500002 |
| ● ● ● | 25 5/8" x 19 1/8" Inch | 44.3 lb | 03426500302 |
| Infobox | | | |
| Washbasin is not ADA compliant in combination with pedestal, siphon cover or metal console | | | |
| Space-saving siphon | 1 1/4" Inch | 0.9 lb | 005076 |
| Suitable products | | | |
| Siphon cover for # 231065, 231060, 231055, 034265, 034285, 034210, 034812, | | | 085718 |
| Pedestal for # 231065, 231060, 231055, 034265, 034285, 034210, 034812, | | | 086327 |
| Vanity unit wall-mounted 1 pull-out compartment, for D-Code # 034265, 23 5/8" x 17 7/8" Inch | 23 5/8" x 17 7/8" Inch | | KT6670 |
| Vanity unit wall-mounted 2 drawers, upper drawer including cut-out for siphon and siphon cover, for D-Code # 034265, 23 5/8" x 17 7/8" Inch | 23 5/8" x 17 7/8" Inch | | KT6650 |
| Vanity unit wall-mounted 1 pull-out compartment, for D-Code # 034265, 23 5/8" x 17 7/8" Inch | 23 5/8" x 17 7/8" Inch | | DS6383 |

D-Code Furniture washbasin & # 03426500002 / 03426500302

| < 25 5/8" Inch > |

| | |
|--|--------|
| Vanity unit wall-mounted 2 drawers, upper drawer including cut-out for siphon and siphon cover, for D-Code # 034265, 23 5/8" x 17 7/8" Inch | DS6483 |
| Vanity unit wall-mounted 1 pull-out compartment, compartment consists of glass dividers and 2 boxes (small/large), for D-Code # 034265, 23 5/8" x 18 1/8" Inch | XL6051 |
| Vanity unit wall-mounted 1 pull-out compartment, for D-Code # 034265, 24 3/8" x 18 1/2" Inch | BR4045 |
| Vanity unit wall-mounted 2 drawers, upper drawer including cut-out for siphon and siphon cover, for D-Code # 034265, 24 3/8" x 18 1/2" Inch | BR4145 |
| Vanity unit floorstanding 2 pull-out compartments, for D-Code # 034265, 24 3/8" x 18 1/2" Inch | BR4425 |

All drawings contain the necessary measurements which are subject to standard tolerances. They are stated in inch & mm and are non-binding. Exact measurements, in particular for customized installation scenarios, can only be taken from the finished ceramic piece.