

D-Code Furniture washbasin & # 03428500002 / 03428500302

| < 33 1/2" Inch > |

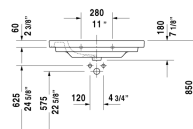
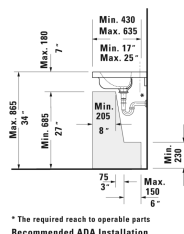
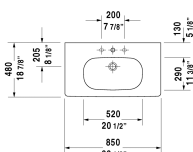
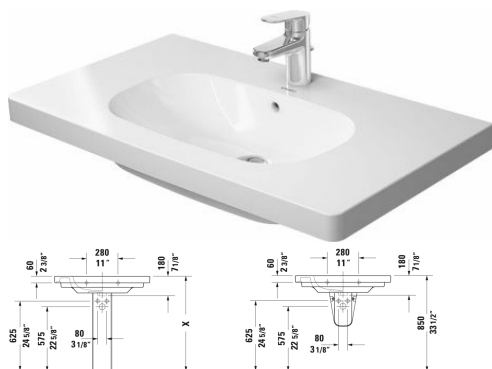

Furniture washbasin	Dimension	Weight	Order number
with overflow, with faucet deck, underside fully glazed, hardware included, wall-mounted, 33 1/2" Inch			
Colors			
00 White			
Variant			
●	33 1/2" x 18 7/8" Inch	55 lb	03428500002
● ● ●	33 1/2" x 18 7/8" Inch	55 lb	03428500302
Infobox			
Washbasin is not ADA compliant in combination with pedestal, siphon cover or metal console			
Towel rail square tube 1/2", Chrome	31 7/8" Inch	1 lb	003036
Space-saving siphon	1 1/4" Inch	0.9 lb	005076
Suitable products			
Siphon cover for # 231065, 231060, 231055, 034265, 034285, 034210, 034812,			085718
Pedestal for # 231065, 231060, 231055, 034265, 034285, 034210, 034812,			086327
Vanity unit wall-mounted 1 pull-out compartment, for D-Code # 034285, 31 1/2" x 17 7/8" Inch	31 1/2" x 17 7/8" Inch		KT6667
Vanity unit wall-mounted 2 drawers, upper drawer including cut-out for siphon and siphon cover, for D-Code # 034285, 31 1/2" x 17 7/8" Inch	31 1/2" x 17 7/8" Inch		KT6647
Vanity unit wall-mounted 1 pull-out compartment, for D-Code # 034285, 31 1/2" x 17 7/8" Inch	31 1/2" x 17 7/8" Inch		DS6384

D-Code Furniture washbasin & # 03428500002 / 03428500302

|< 33 1/2" Inch >|

Vanity unit wall-mounted 2 drawers, upper drawer including cut-out for siphon and siphon cover, for D-Code # 034285, 31 1/2" x 17 7/8" Inch	31 1/2" x 17 7/8" Inch	DS6484
Vanity unit wall-mounted 1 pull-out compartment, compartment consists of glass dividers and 2 boxes (small/large), for D-Code # 034285, 31 1/2" x 18 1/8" Inch	31 1/2" x 18 1/8" Inch	XL6048
Vanity unit floorstanding 2 pull-out compartments, upper drawer including cut-out for siphon and siphon cover, for D-Code # 034285, 31 1/2" x 18 1/2" Inch	31 1/2" x 18 1/2" Inch	XL6516
Vanity unit wall-mounted 1 pull-out compartment, for D-Code # 034285, 32 1/4" x 18 1/2" Inch	32 1/4" x 18 1/2" Inch	BR4046
Vanity unit wall-mounted 2 drawers, upper drawer including cut-out for siphon and siphon cover, for D-Code # 034285, 32 1/4" x 18 1/2" Inch	32 1/4" x 18 1/2" Inch	BR4146
Vanity unit floorstanding 2 pull-out compartments, for D-Code # 034285, 32 1/4" x 18 1/2" Inch	32 1/4" x 18 1/2" Inch	BR4426

All drawings contain the necessary measurements which are subject to standard tolerances. They are stated in inch & mm and are non-binding. Exact measurements, in particular for customized installation scenarios, can only be taken from the finished ceramic piece.