

Vero Handrinse basin # 0702250000

< 9 7/8" Inch >

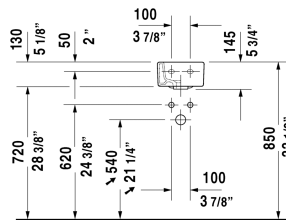
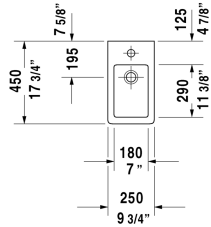

| Handrinse basin  | Dimension             | Weight  | Order number |
|--|-----------------------|---------|--------------|
| with overflow, with faucet deck, underside fully glazed, wall-mounted, hardware included, cUPC® listed*, 9 7/8" Inch   |                       |         |              |
| <b>Colors</b>  |                       |         |              |
| 00 White   |                       |         |              |
| <b>Variant</b>   |                       |         |              |
| ●  | 9 7/8" x 17 3/4" Inch | 19.6 lb | 0702250000   |
| <b>Infobox</b>   |                       |         |              |
| * Complies with following standards: ASME A112.19.2/CSA B45.1  |                       |         |              |
| Sanitary ceramics with the special WonderGliss surface finish will remain clean and attractive-looking for a long time to come.<br>When ordering WonderGliss please add a "1" as eleventh digit to the model number. |                       |         |              |

All drawings contain the necessary measurements which are subject to standard tolerances. They are stated in inch & mm and are non-binding. Exact measurements, in particular for customized installation scenarios, can only be taken from the finished ceramic piece.