

**D-Code Bathtub # 700095000000090**

| &lt; 59" Inch &gt; |

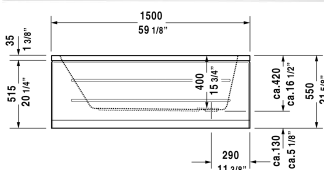
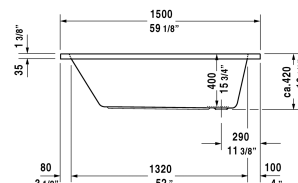
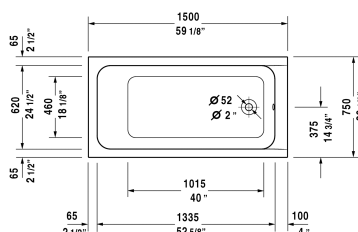

Bathtub	Dimension	Weight	Order number
rectangle, with one backrest slope, outlet in foot area, CUPC® listed*, Sanitary acrylic , Filling capacity 26 gal			
<b>Colors</b>			
00 White			
<b>Variant</b>			
drop-in or for panel, incl. support frame, Base tub	59" x 29 1/2" Inch	38.5 lb	700095000000090
<b>Infobox</b>			
* Complies with the following standards: CSA B45.5/IAPMO Z124, Minimum order qty. = 10 pcs.			
<b>Suitable products</b>			
Tile flange ,			790112
Cable-driven waste and overflow ,			790220
Bathtub anchors for mounting and support of D-Code/D-Neo bathtubs and D-Code shower trays, 3 pieces,			790125
Panel front, for bathtubs, *, 59",			701039
Panel right, for bathtubs, *, 29 1/2",			701044
Panel left, for bathtubs, *, 29 1/2",			701047
Support frame (included), for bathtubs,			790133
Waste and overflow brass, Chrome trim,			791255

All drawings contain the necessary measurements which are subject to standard tolerances. They are stated in inch & mm and are non-binding. Exact measurements, in particular for customized installation scenarios, can only be taken from the finished ceramic piece.