

**TOOLS REQUIRED
OUTILS REQUIS**

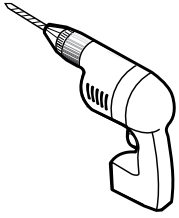

DRILL
PERCEUSE

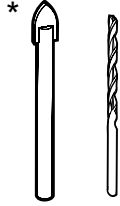

1/4" & 1/8" DRILL BITS
MÈCHE 1/4" & 1/8"

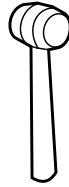

MALLET
MAILLET



SCREWDRIVER
TOURNEVIS

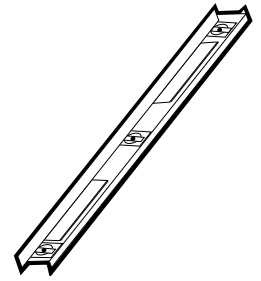

LEVEL
NIVEAU



PENCIL
CRAYON

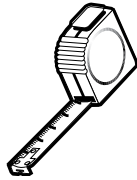

TAPE MEASURE
RUBAN À MESURER



LONG NOSE LOCKING PLIERS (X2)
PINCE SERRE ÉTAU (X2)

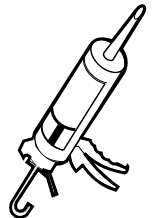

SILICONE
SCELLANT

* Use a 1/4" drill bit for ceramic when drilling into ceramic tiles
* Utiliser une mèche à céramique de 1/4" lors du perçage des tuiles.

**POSSIBLE CONFIGURATIONS
CONFIGURATIONS POSSIBLES**

SHOWER / DOUCHE

SHOWER / DOUCHE

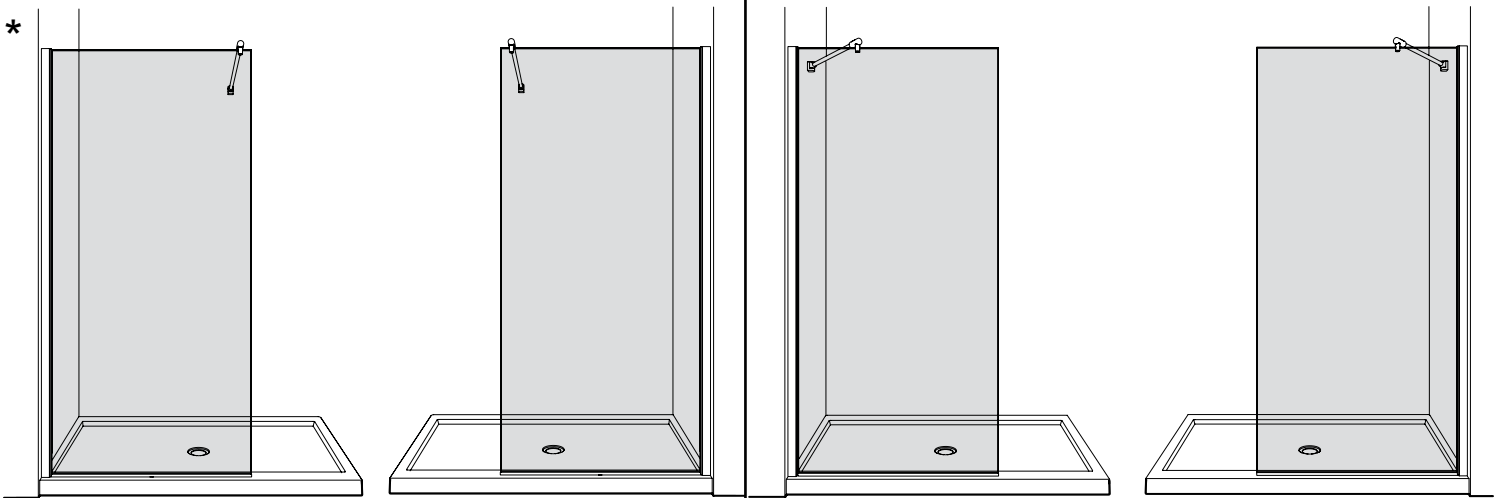

* THIS CONFIGURATION IS ILLUSTRATED IN THIS MANUAL. FOLLOW THE SAME STEPS FOR THE SHOWER.

* CETTE CONFIGURATION EST ILLUSTRÉE DANS CE MANUEL. SUIVRE LES MÊMES ÉTAPES POUR LA DOUCHE

PARTS AND HARDWARE LISTING
LISTE DES PIÈCES ET QUINCAILLERIE

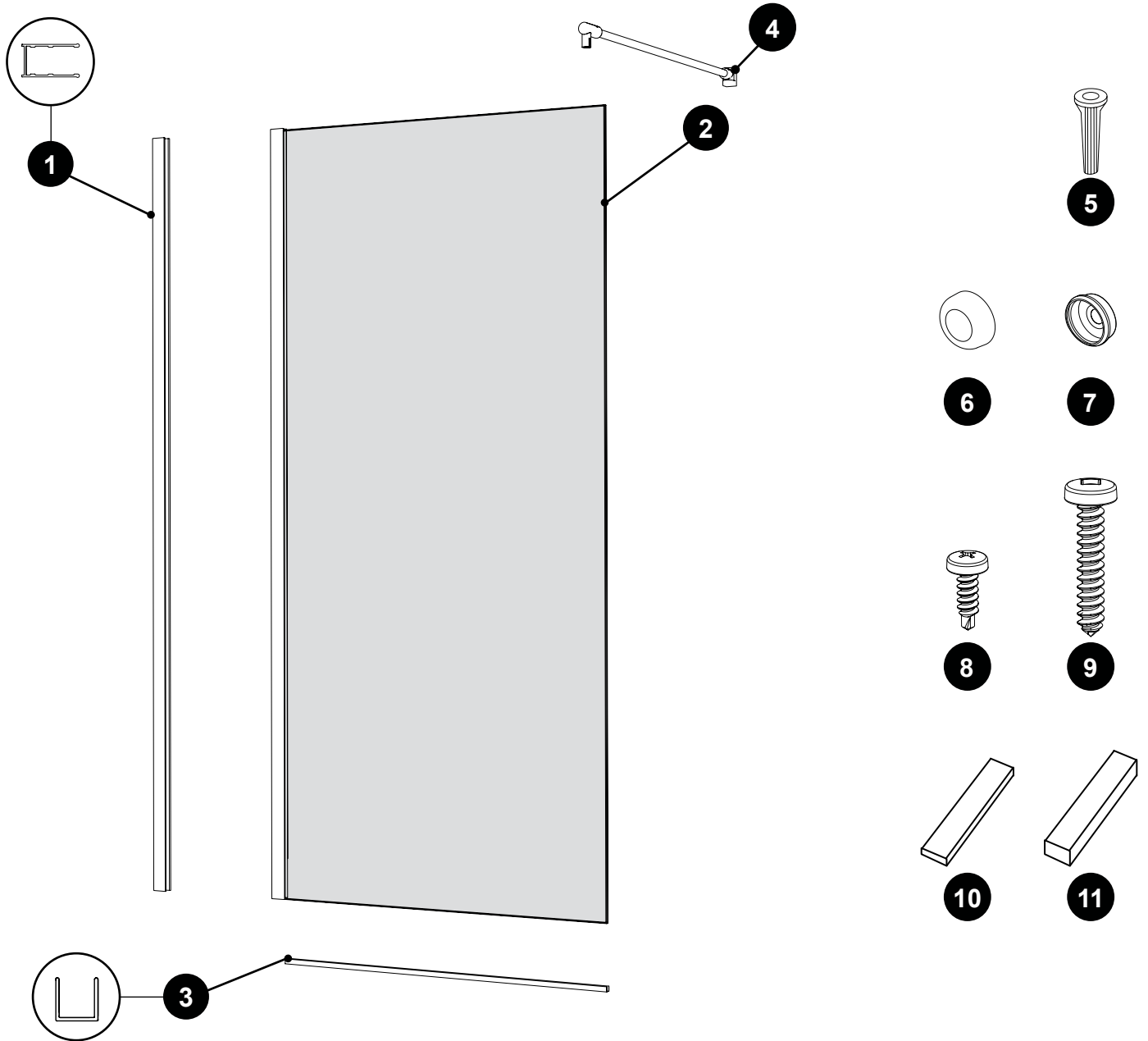

ITEM	PARTS AND HARDWARE / PIÈCES ET QUINCAILLERIE	QTY
1	WALL JAMB (REGULAR PUNCH) / JAMBAGE (PERÇAGE RÉGULIER)	1
2	FIXED PANEL / PANNEAU FIXE	1
3	“U” CHANNEL / PROFILÉ EN «U»	1
4	SUPPORT BAR / BARRE DE SUPPORT	1
5	WALL PLUGS / CHEVILLE	3
6	SCREW CAP / CAPUCHON COUVRE-VIS	3
7	BACK SCREW CAP / L'ARRIÈRE DU CAPUCHON COUVRE-VIS	3
8	PAN SELF DRILLING SCREW # 8- 3/8" / VIS PAN AUTO-PERÇANTE # 8- 3/8"	3
9	PAN SELF-DRILLING SCREW # 8- 1-1/4" / VIS PAN AUTO-PERÇANTE # 8- 1-1/4"	3
10	CLEAR SETTING BLOCK 1/16" / BLOC À NIVEAU TRANSPARENT 1/16"	2
11	CLEAR SETTING BLOCK 1/8" / BLOC À NIVEAU TRANSPARENT 1/8"	2