



**Brenham™**  
Wall-Mount Bathroom Sink  
**K-1997-8N**

**Features**

- 8-inch center faucet holes.
- Oval basin.
- Sealed overflow drain.
- Includes wall hanger.

**Material**

- Vitreous china.

**Installation**

- Wall-mount.
- Drilled for concealed arm carrier installation.

**Optional Products/Accessories**

K-8998 P-Trap  
K-1998 Shroud

**Included Components**

Additional Components:  
Hanger(s) (Qty 2)



ADA

CSA B651

OBC

**Codes/Standards**

ASME A112.19.2/CSA B45.1  
ADA  
ICC/ANSI A117.1  
CSA B651  
OBC

**KOHLER® One-Year Limited Warranty**

See website for detailed warranty information.

**Available Colors/Finishes**

*Color tiles intended for reference only.*

**Color Code Description**



0 White

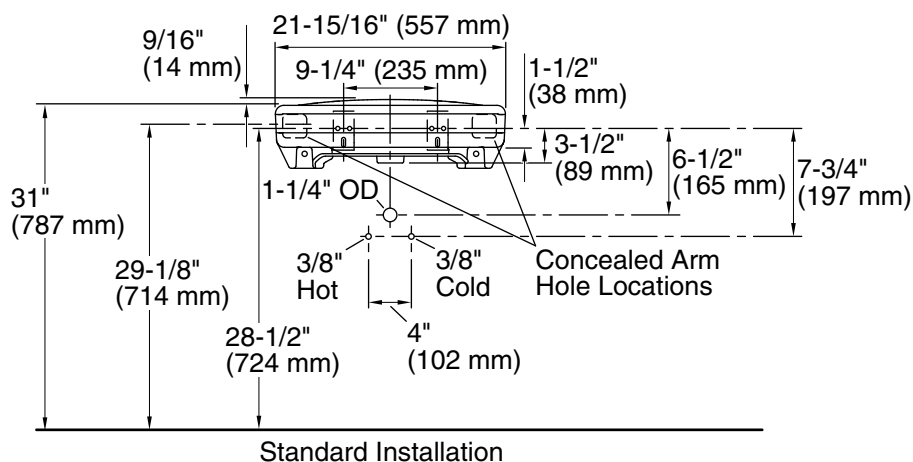
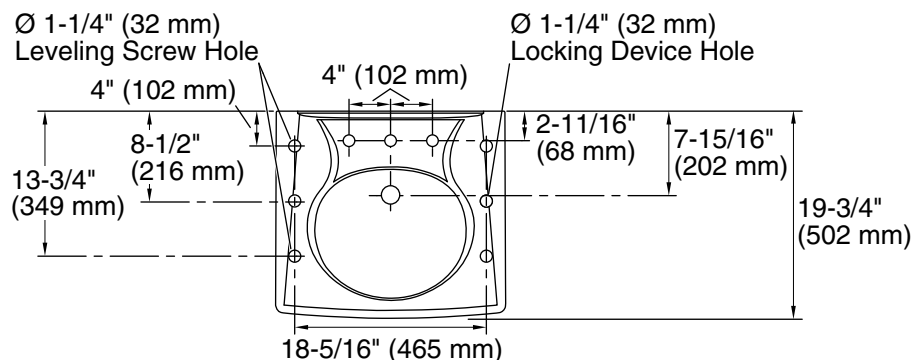

Standard Installation

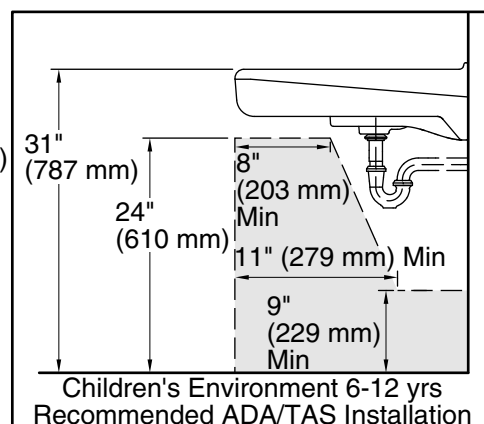
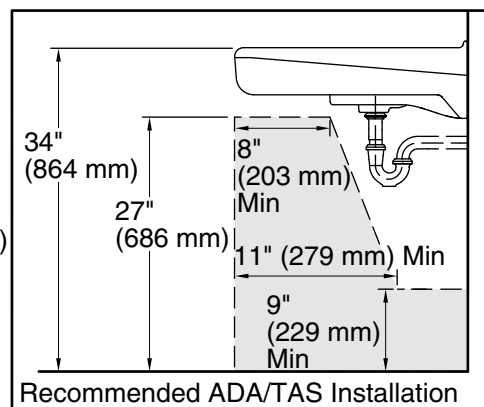

## Technical Information

All product dimensions are nominal.

Bowl configuration: Single

Installation: Wall-mount

Bowl area (Only): Length:  $14\text{-}3/8"$  (365 mm)  
Width:  $12\text{-}5/16"$  (313 mm)  
With overflow: Yes  
Water depth:  $3\text{-}1/4"$  (83 mm)

Number of deck holes: 3

Faucet hole spacing: 8" (203 mm)

Faucet hole(s):  $1\text{-}3/8"$  (35 mm)

Drain hole:  $1\text{-}3/4"$  (44 mm)

## Notes

Install this product according to the installation instructions.

ADA, OBC, CSA B651 compliant when installed to the specific requirements of these regulations.