

# KHU103-32

## 32 Inch Undermount Double Bowl Stainless Steel Kitchen Sink

### Sink Dimensions

Overall Dimensions: 32" x 19"

Larger Bowl Dimensions: 18" x 17"

Smaller Bowl Dimensions: 12" x 17"

Sink Depth: 10"

### Features

- 16 Gauge Stainless Steel Construction
- Undermount Installation
- Double Bowl 60/40 Sink
- Required Minimum Cabinet Size: 36" Left to Right, 24" Front to Back
- Rear Center-Set Drains
- 3 1/2" Drain Opening
- NoiseDefend Undercoating and Sound Dampening Pads

### Accessories Included

- Strainer ST-1 x2
- Cover Cap STC-2 x2
- Bottom Grid KBG-103-32-1
- Bottom Grid KBG-103-32-2
- Cut-Out Template
- Mounting Hardware
- Towel

### CODES/STANDARDS:

#### Product Certification

cUPC (ASME A112.19.3/CSA B45.4)

### Warranty

Kraus Limited Lifetime Warranty

see website for details [www.kraususa.com](http://www.kraususa.com)

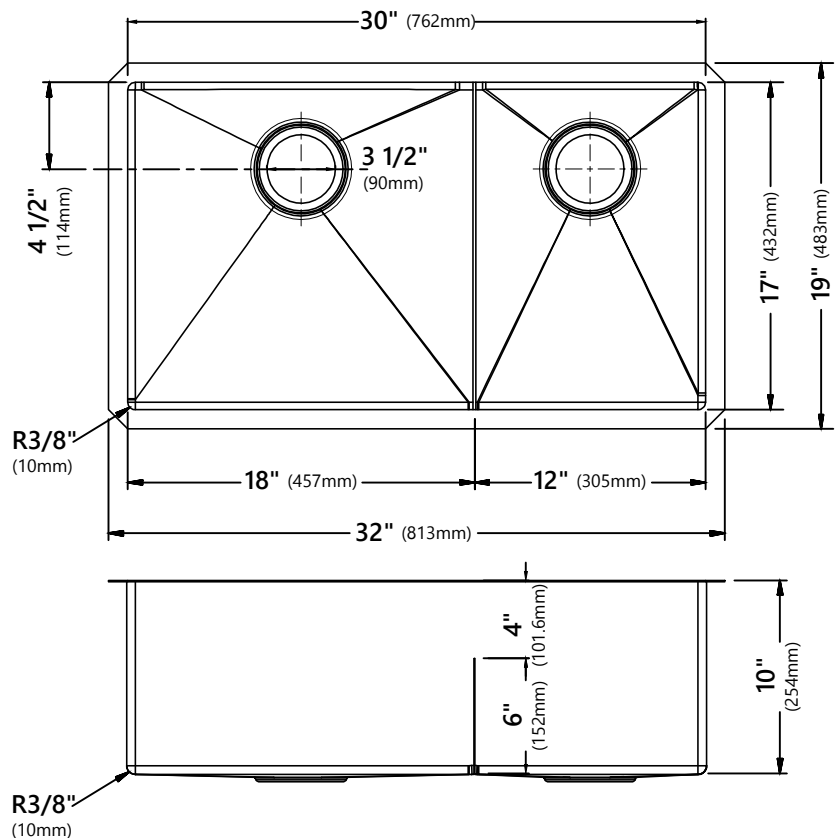

## KBG-103-32-1

### Stainless Steel Kitchen Sink Bottom Grid

#### Grid Dimensions

Overall Dimensions: 17 5/8" x 16 5/8" x 7/8"

#### Features

- Commercial grade stainless steel construction
- For Use with the KHU103-32 kitchen sink
- Protects bottom of sink from daily wear and tear
- Rubber feet provide additional protection

#### Warranty

Kraus One Year Limited Warranty

see website for details [www.kraususa.com](http://www.kraususa.com)

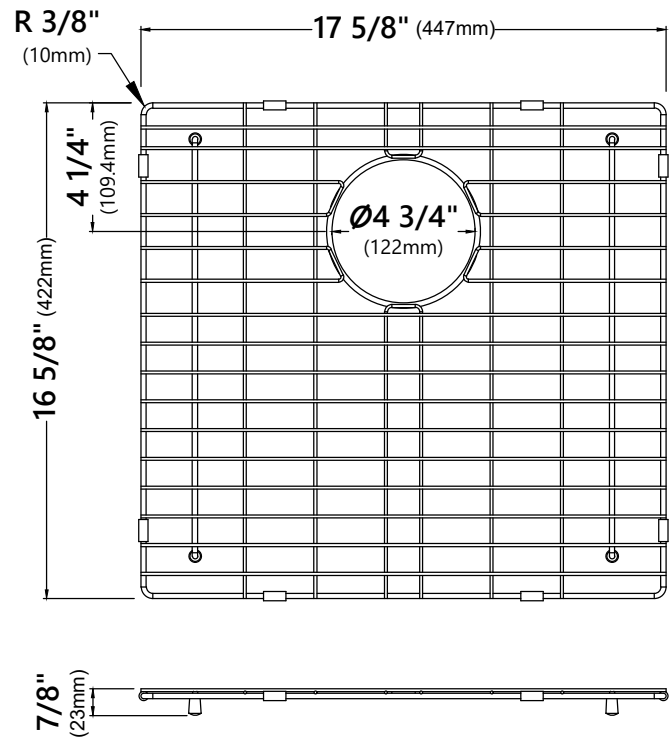
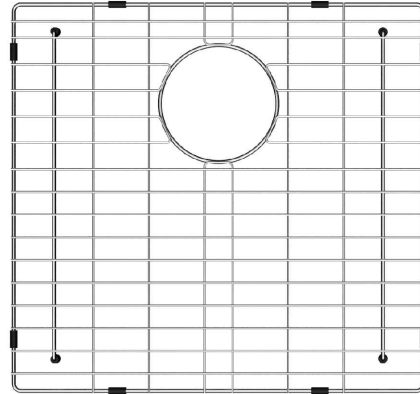

## KBG-103-32-2

### Stainless Steel Kitchen Sink Bottom Grid

#### Grid Dimensions

Overall Dimensions: 11 5/8" x 16 5/8" x 7/8"

#### Features

- Commercial grade stainless steel construction
- For Use with the KHU103-32 kitchen sink
- Protects bottom of sink from daily wear and tear
- Rubber feet provide additional protection

#### Warranty

Kraus One Year Limited Warranty

see website for details [www.kraususa.com](http://www.kraususa.com)

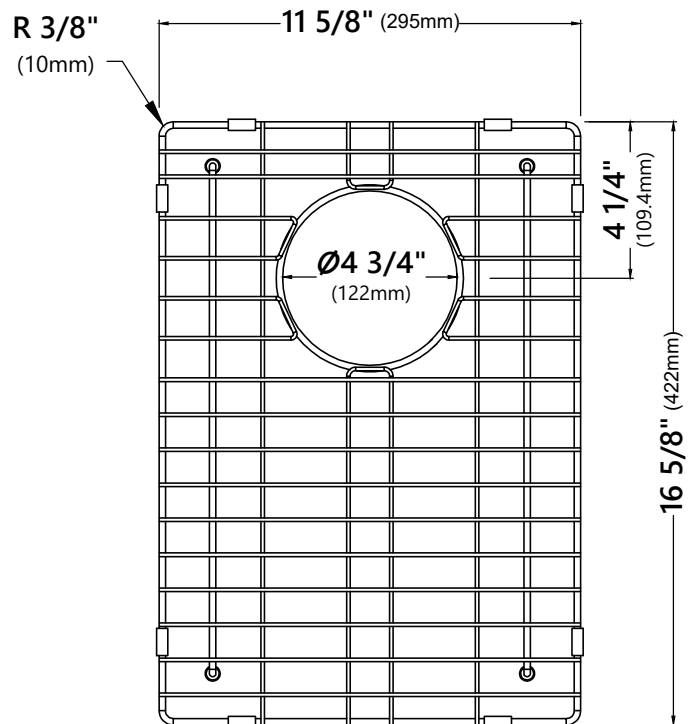
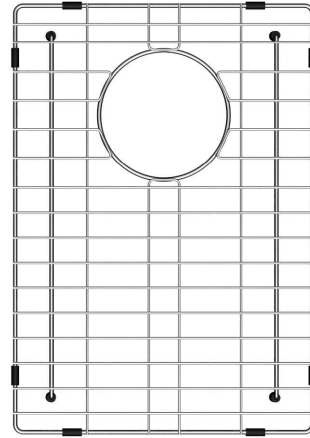

## ST-1

### Stainless Steel Kitchen Sink Strainer

#### Strainer Dimensions

Overall Dimensions:  $\phi 4 \frac{1}{2}" \times 3 \frac{3}{4}"$

#### Features

- Premium Stainless Steel construction
- Fits Standard  $3 \frac{1}{2}"$  or  $4"$  Drain Opening
- Open/Close Stopper Prevents Debris from Clogging Drain Pipe

#### Available Finishes

- Stainless Steel



#### Warranty

Kraus Limited Lifetime Warranty

see website for details [www.kraususa.com](http://www.kraususa.com)

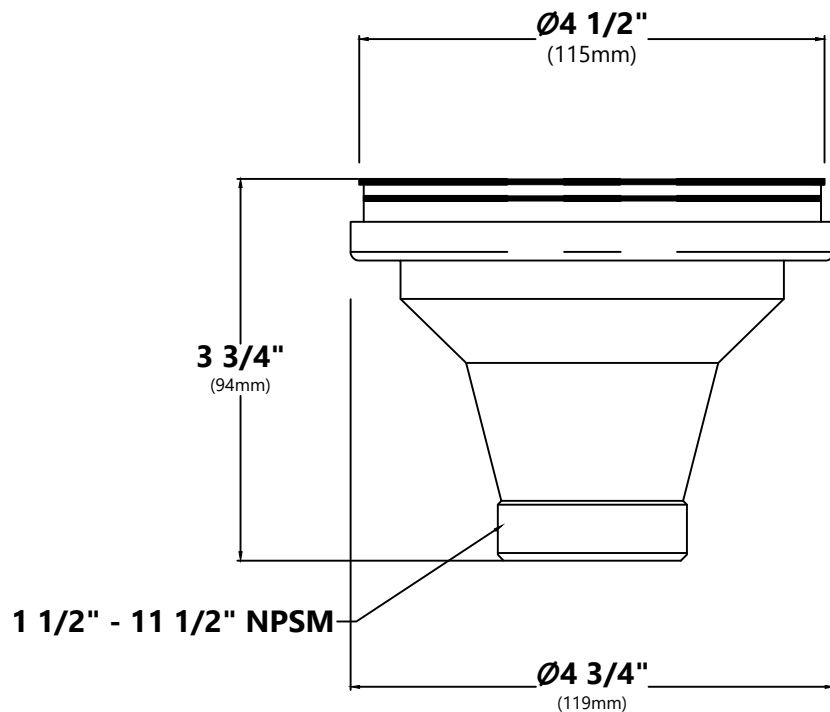

## STC-2

### Removable Decorative Drain Cover

---

#### Drain Cap Dimensions

Overall Dimensions: Ø4 1/2" x 5/8"

#### Features

- Premium Stainless Steel Construction
- Fits Standard 3 1/2" Drain Opening
- Allows Water to Drain Easily When Installed
- Conceals Garbage Disposal and Waste Fittings for a Seamless Look
- Compatible with Standart Pro™, Pax™, Kore™, Outlast Microshield™ and Premier™ Kitchen sinks

#### Available Finishes

- Stainless Steel
- PVD Gunmetal



#### Warranty

Kraus Limited Lifetime Warranty

see website for details [www.kraususa.com](http://www.kraususa.com)

