

1. Check the packed bags with numbers than open them.
2. Screw the (A) Lamp Derrick into the (B) Wick
3. Hange the (C) Lamp tube with rope to the (B) Wick and (D) Suspension Loop.
4. Put (F) Socket Shade cover on the (G) Socket and then screw the (E) Bulb on the (G) Socket .

RL6077C-16BK

Cautions of installation

Install the bulbs

Hold the bulb firmly (you should not touch the hardware part in case of electric shock) and then install it clockwise until it is firm

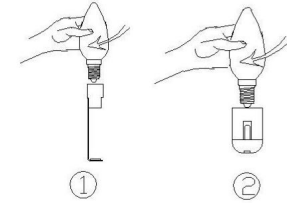

1. Check the packed bags with numbers then open them.
2. Bulbs not included.

